



**PUMP  
PAZH**

PUMP SYSTEM MANUFACTURING

# PROGRESSIVE TECHNOLOGIES

PROGRESSING CAVITY SCREW PUMPS

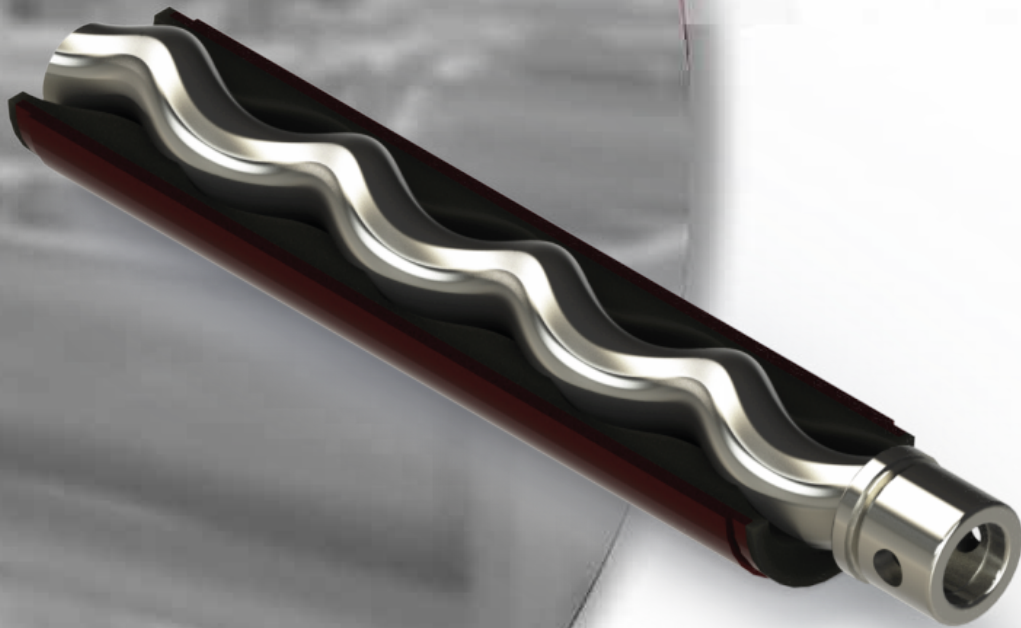

# PH031502

TECHNICAL PUMP SPECIFICATIONS

# PH031S02

## مشخصات فنی

|                           |                                 |
|---------------------------|---------------------------------|
| 12 BAR                    | حداکثر فشار کاری / Max Pressure |
| 0,5-1,8 M <sup>3</sup> /H | ظرفیت / Capacity                |
| 0,75-1,5 Kw               | توان مصرفی / Power              |
| 262-545 RPM               | سرعت چرخش / Speed               |
| 0.9/1.3 MM                | ذرات جامد / Solid               |
| 60 Kg                     | وزن / Weight                    |



| PH031 SERIES | L1  | L2  | L3   | Out., DN | L4  | D  | d  |
|--------------|-----|-----|------|----------|-----|----|----|
| 031S01       | 270 | 220 | 970  | 50       | 162 | 70 | 30 |
| 031S02       | 270 | 220 | 1105 | 50       | 304 | 70 | 30 |
| 031S04       | 300 | 250 | 1720 | 50       | 588 | 70 | 31 |
| 031L01       | 270 | 220 | 1105 | 50       | 304 | 70 | 30 |

## منحنی عملکردی

